

Pleasanton Public Library

A Brief History



1909-1912



The first Reading Room was opened in 1909 by the Women's Improvement Club who raised \$1,100 to purchase land on the corner of Main and Division Streets

1912-1962



In 1912, the Women's Improvement Club donated this piece of property to the City for the construction of a City Hall. The library occupied a spacious room in City Hall until 1962. This building currently houses the Museum on Main.

1962-1967



Due to the increase in the City's population and the need for a larger City Hall, a new library was opened at 660 Main in 1962. In 1964, the City turned over library operations to Alameda County.

Between 1960 and 1970, the population in Pleasanton continued to grow from approximately 4200 to 18000. Library circulation also grew rapidly during this time from 30,000 to 150,000.

1962-1967



This library facility stayed in operation until 1967. From December 1967 to April 1968 there was no library in Pleasanton. All books were stored at the Alameda County Fairgrounds while a new location was secured.

SLIGHT OF HAND - When you can hold the attention of this many youngsters all at the same time you've accomplished something. To find out what sight has enthralled the children above turn to today's Lively Arts section of the Independent.
INDEPENDENT AUG 21, 1966 P. 1

1968-1973



In April of 1968, a modular building was placed on Abbie Street to temporarily house the library. Displeased with the look and feel of a modular building, this library became a source of controversy and was called a “blight” on the town. This controversial building was heavily used and remained on this site until 1973.

ABBIE ST. MODULAR LIBRARY



A PLACE TO CALL THEIR OWN— Leslie Unger, 3, and her brother Tom, 5, relax in the library they waited for so long. The children of Mr. and Mrs. Walter Unger, 1594 Loganberry way were among several residents looking over the newly-opened facilities. It includes a children's section, study desks for students and soft chairs for adults. Librarian Phyllis Jardine unlocked the doors for the public Monday. The building is on Abbie just off Main street. **TIMES 5-1-68**

1973-1988



In 1973, a permanent home was built for the library on Black Avenue. This is the current site of Gingerbread Preschool. This library saw a population growth from approximately 20,000 to nearly 50,000 residents.

1988-PRESENT



On November 12, 1988, the current library site opened at 400 Old Bernal Avenue.

In 1999, the City reassumed the operation of library services from Alameda County.

The population of Pleasanton and library circulation have both grown from the opening of the first Reading Room in 1909 to the present. In 1911, circulation was 300 with a population of approximately 1200. Today, library circulation approaches nearly 1.5 million each year with a population of approximately 75,000.

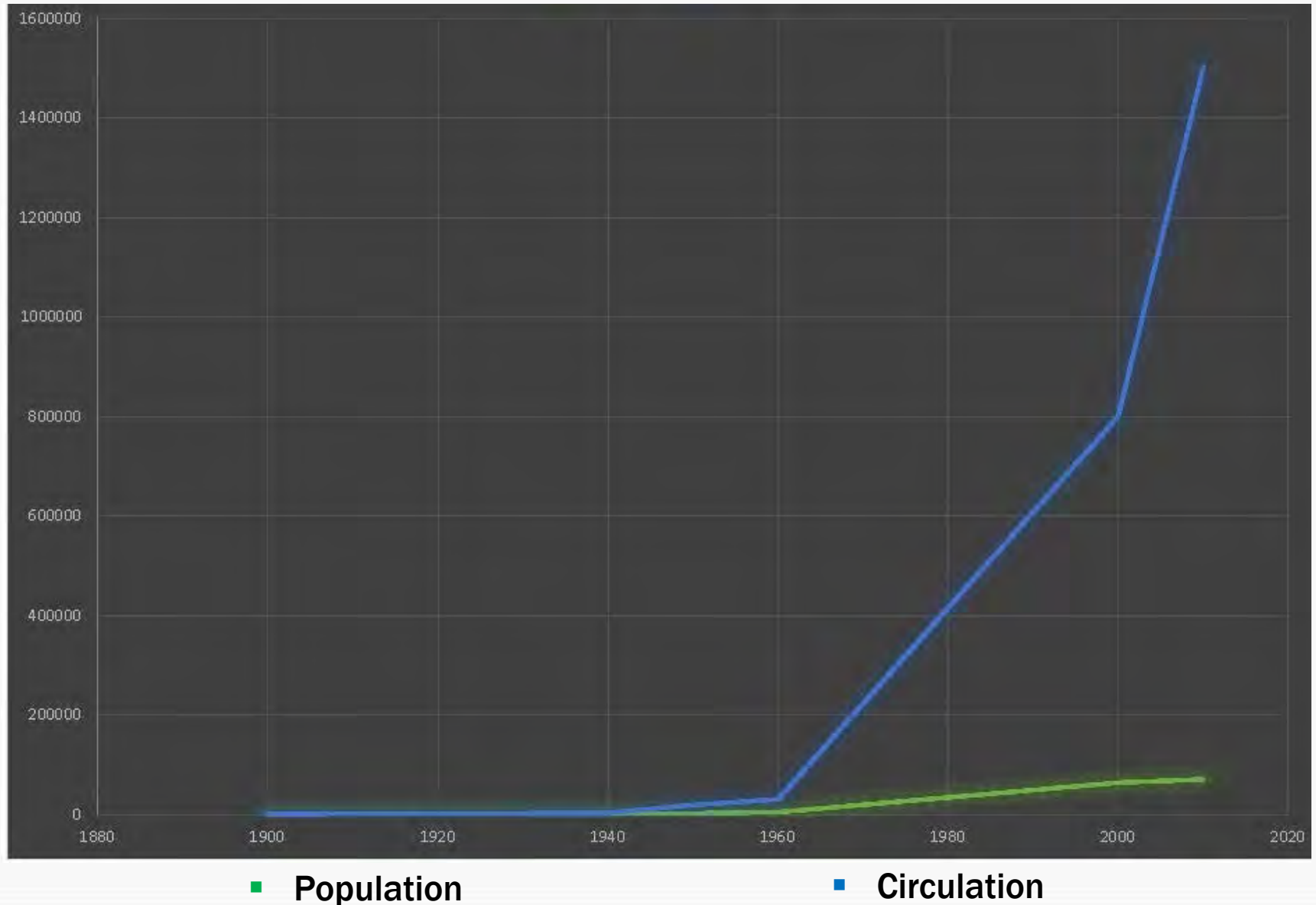

DEMOGRAPHICS HAVE ALSO SHIFTED DRAMATICALLY OVER TIME

2000

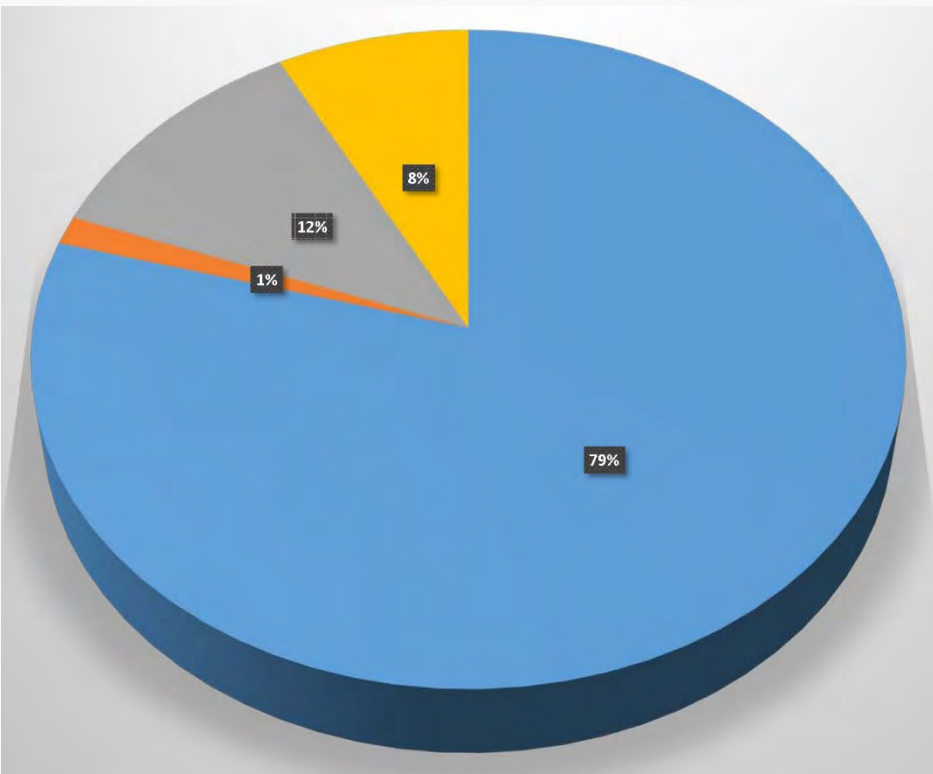

2010

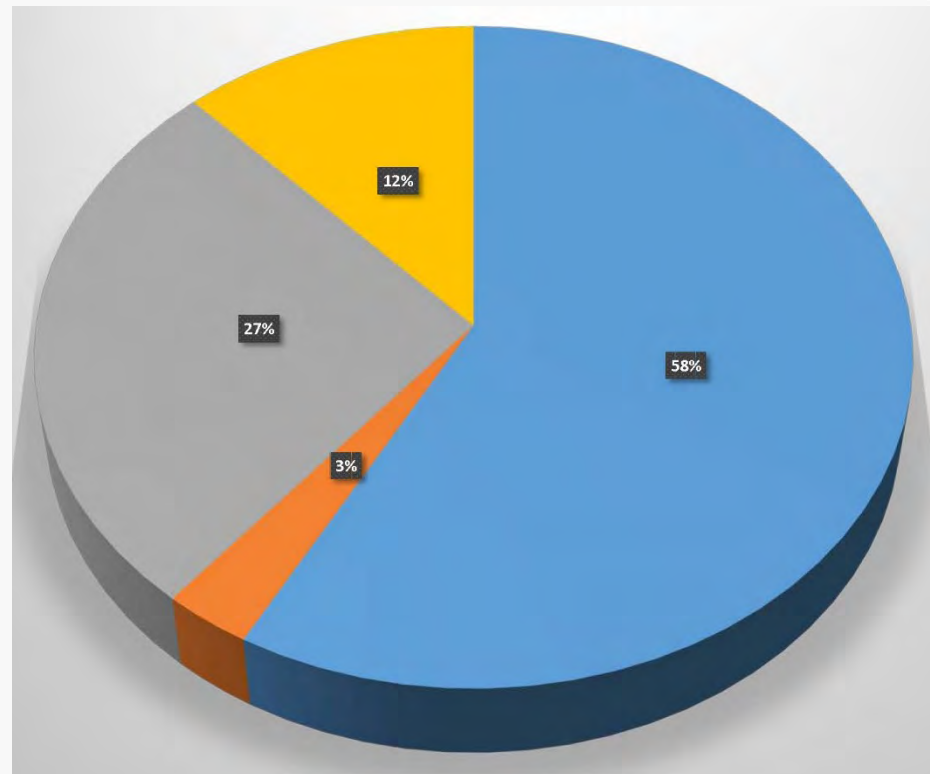

■ White

■ Hispanic

■ Asian

■ African
American

CHILDREN'S AND FAMILY PROGRAMS



The library today provides robust programs, collections and services for children of all ages and their parents and caregivers. Programs such as storytimes, author visits, and special performers draw large crowds each week. Please visit the Children's Room for more information.

CHILDREN'S AND FAMILY PROGRAMS



Chronicle / Michael Macor



CHILDREN'S AND FAMILY PROGRAMS



CHILDREN'S AND FAMILY PROGRAMS



ADULT PROGRAMS AND SERVICES



The library provides a wide array of programs, services and collections to meet the unique needs of our community, including: English as Second Language Clubs, Literacy Tutoring, Book Clubs, Resume/Job Searching Assistance, Research Support, Reader's Advisory and much more! Please visit the Reference Desk for more information.

ADULT PROGRAMS AND SERVICES



ADULT PROGRAMS AND SERVICES



TECHNOLOGY



The library offers public desktop and laptop computers, free wi-fi, printing and technology assistance during all open hours.

COLLECTIONS/GENERAL INFORMATION

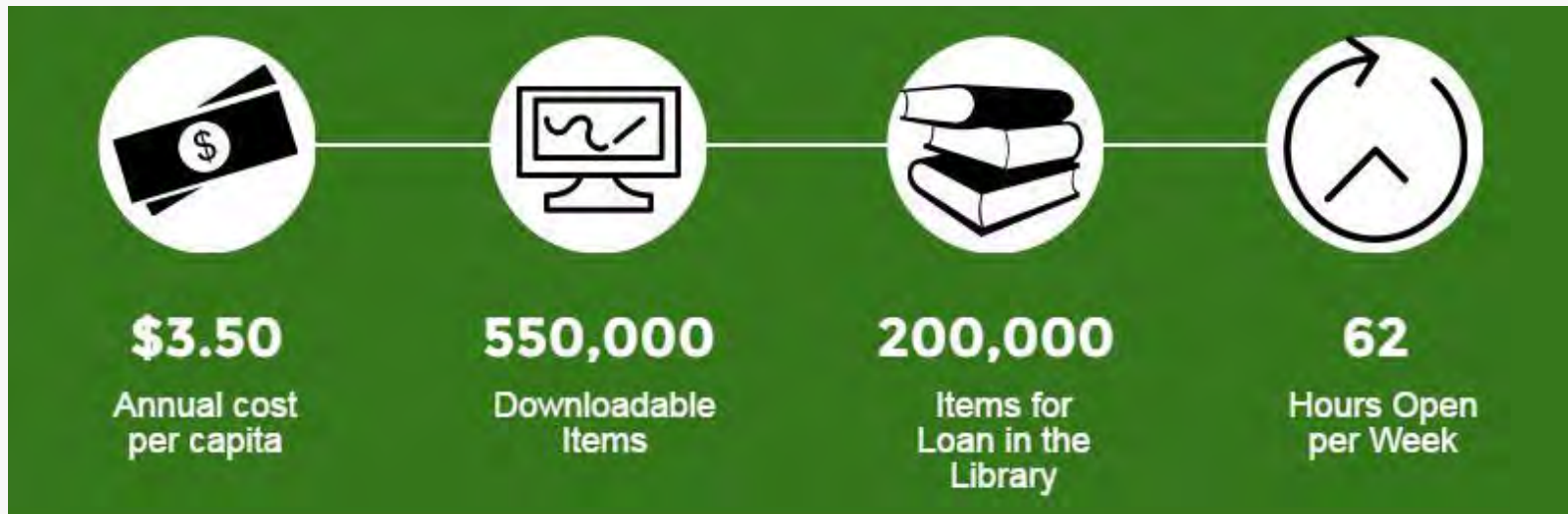

The library offers books, magazines, newspapers, DVDs, CDs, and audiobooks for loan to all ages, free with your library card.

Additionally, eBooks, audiobooks, databases, music, movies and more are available to download free with your library card from the comfort of your own home or in the library.

Library cards are available for free to all! Please visit any one of our desks to find out more about the library.

FUTURE

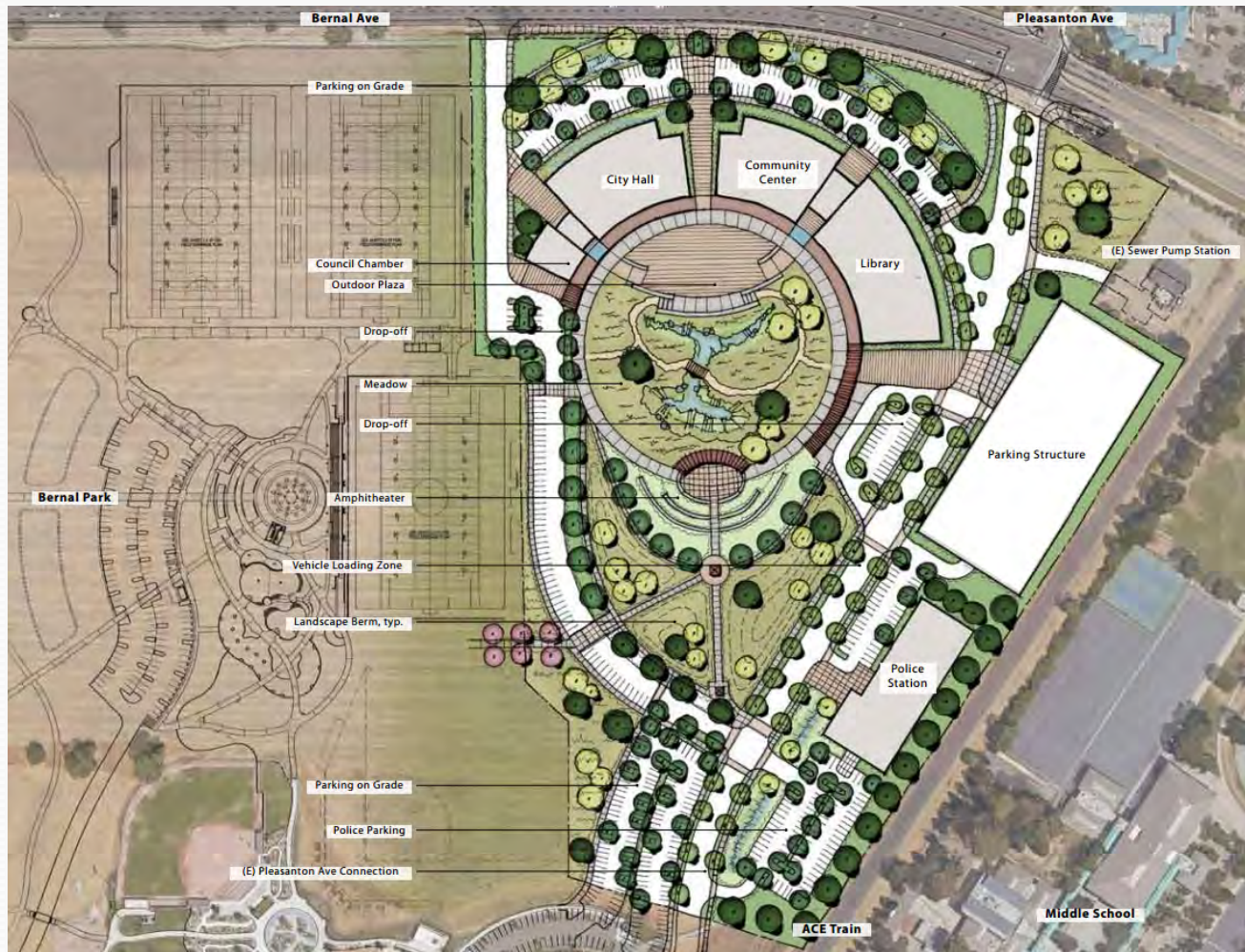

On November 15, 2016, the City Council approved a Master Plan for the new Civic Center Campus on the Bernal Property between the sports fields and Pleasanton Middle School. This plan includes a 70,000 sq. foot Library combined with a 25,000 sq. foot Community Center. This plan is expected to be on the ballot for public input in November 2018. A scale model and additional maps are in the Library lobby.